



Tribute® Wrap Head & Neck

Adjustable foam
compression wrap

Adaptives Kompressionssystem
aus Schaumstoff

Système de compression
en mousse réglable

Venda semirrígida para terapia
compressiva ajustable de espuma

Sistema compressivo
regolabile con imbottitura

Verstelbaar

schuimcompressiesysteem

Adaptívny penový
kompresívny systém

Uyarlanabilir köpük
kompresyon sistemi

Justerbar
skumkompressionssystem

Justerbart
skumkompressionssystem

رباط ضاغط فوم قابل للتعديل

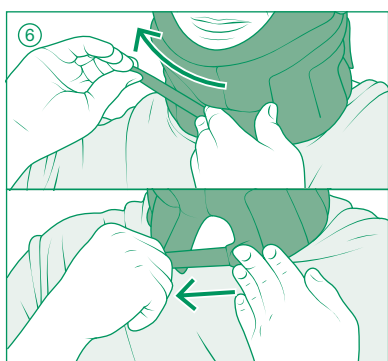
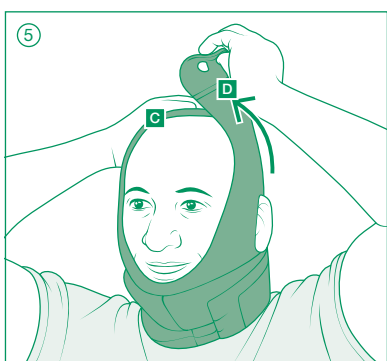
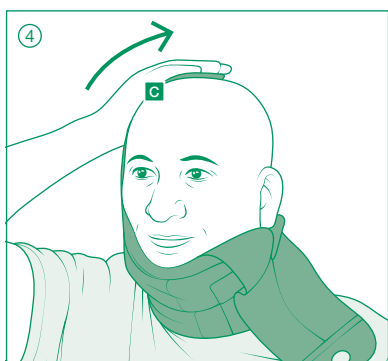
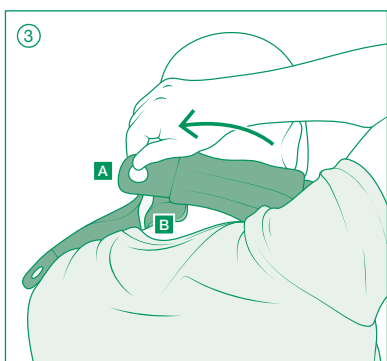
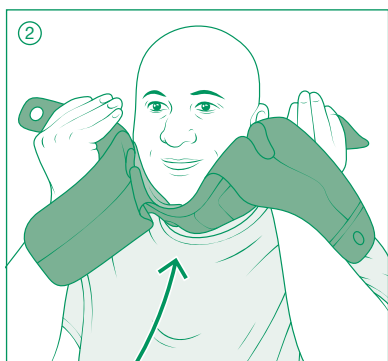
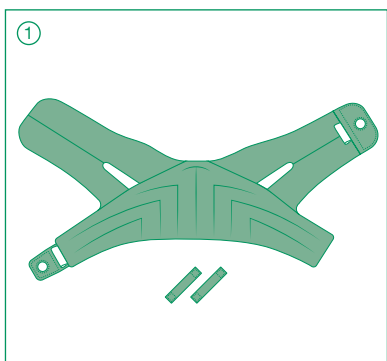

Thank you for choosing Tribute® Wrap!

Tribute Wrap Head & Neck is an off-the-shelf adjustable foam garment for the self-management of indicated conditions of the head and neck during the evening, night, or low activity. Tribute Wrap comfortably adjusts to your unique shape to help maintain gains made during therapy, while allowing the flexibility to support further reduction.

Please consult a trained medical professional prior to first use.

Indications and patient groups

- Various stages of lymphedema
- Various stages of lipedema
- Edema

Intended uses

- Helps maintain reduced volume and shape by supporting extremities
- Management of various stages of lymphedema
- Management of various stages of lipedema
- Management of edema
- Assists in softening of indurated/fibrotic tissue
- Help increase tissue oxygenation

Contraindications

- Arterial insufficiency or ABPI < 0.8
- Moderate to severe peripheral arterial disease
- Acute DVT
- Untreated congestive heart failure
- Untreated cancer
- Untreated infection (e.g. cellulitis)
- Known allergy and/or hypersensitivity to any of the product components
- Severe cognitive impairment

Precautions

- Impaired sensation (peripheral neuropathy)
- Cognitive impairment
- Any open wounds should be dressed prior to application
- Ensure stoma is not obstructed during garment use

Side effects

In (very) rare cases, skin irritations and/or allergies may occur.

Serious incident

In case of serious incident, contact the manufacturer and the responsible health authorities.

Ensure all garment components are present prior to use:

- Head & Neck garment x 1
- Compression Straps (8 cm) x 2

Donning instructions

- ① **Unfasten** all garment straps and identify the head and neck straps (labeled on garment tags).
- ② **Hold** the neck straps with the grey side facing toward you and place it around your neck.
- ③ **Pull** neck strap with finger grip **(A)** and fasten it on top of the opposite strap **(B)** around back of neck. Adjust for fit and comfort.
 - ◆ For the Head & Neck garment with Tracheostomy Accommodation, align the opening with the stoma to ensure airway is not covered.
- ④ **Place** the strap without hook **(C)** on top of head and hold in place.

- ⑤ **Pull** strap with finger grip **(D)** and fasten on top of the opposite strap **(C)** on top of head. Adjust for fit and comfort.

- ◆ The long black straps can be fastened with the ears under or through the strap opening.

Optional Step

Apply the included Compression Straps to the exterior of the garment as directed by your trained medical professional to support your needs, such as:

- ◆ Providing focused tension
- ◆ Securing garment around stoma

Care instructions

L&R recommends all Tribute Wrap garments be washed and dried before the first extended use.



Fasten straps to garment prior to laundering.

- Machine wash in cold water
- Do not use fabric softener or bleach
- Do not dry clean
- Tumble dry low heat with other laundry items
 - ◆ Shorten drying time by pressing out excess water with a towel or tumbling with clean tennis balls
- Do not iron



Material content

Blend of: nylon (polyamide), polyurethane, spandex (elastane)
Not made with natural rubber latex.

Warranty

We guarantee your Tribute Wrap garment to be free of material and manufacturing defects during the recommended six month life of the garment.

Disposal

Observe current national regulations and laws for disposal of this device. Packaging marked recyclable should be properly recycled, otherwise disposed of with household waste.